

Pearl Black (PB)

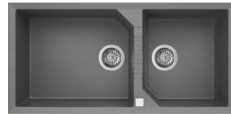

Pearl White (WH)



Titanium (TI)



Resistance to impact



Resistance to thermal shocks



Antibacterial Protection



UV protection, no discolouration overtime



Easy clean bowl angle

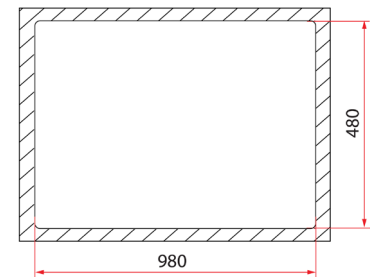
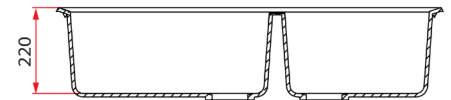
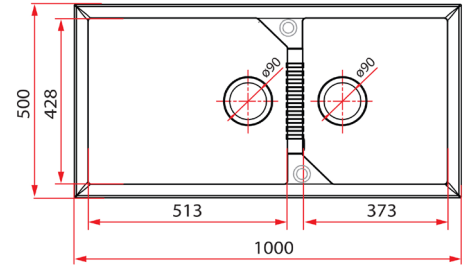

* Measured in Millimeters (mm)

* Product dimension and cut-out specification is for reference only.

METEOR series of kitchen sinks are made from natural granite and acrylic resin; they are manufactured through an exclusive technological process that fired the sink at 700°C which increased its durability and hardness. Thus, granite sinks are of high resistance to thermal shock and scratches, also it has an antibacterial protection via enriching the mass with silver ions and inhibits the growth of bacteria. Available in different configurations & sizes and comes in 3 popular colours, Pearl Black, Titanium Sliver and Pearl White. At Rubine, we definitely have a choice of sink to match your kitchen.

Product Information	
Model	MEQ 860-100 PB / MEQ 860-100 WH / MEQ 860-100 TI
Material	Granite
Surface Finishing	Ceramization
Colour	Pearl Black (Current) / Pearl White (Indent) / Titanium (Indent)
Installation	Inset
Pre-Punch Tap Hole	Nil
Sound Deadening Pads	No
Reversible	Yes
Overflow	Yes
Minimum Cabinet	1200mm
Overall Dimension	1000 x 500 x 220mm
Bowl Dimension	513 x 428mm / 373 x 428mm
Package Included	Kitchen Sink + 3½" Strainer Waste + Cut-Out Template + Clips + Sealing Tape
Warranty (T&C's Apply)	5 Years Against De-Colouring On Sinks Surface (proper maintenance)

*Copyright. All Rights Reserved. Rubine is constantly improving its products and make changes if deemed necessary.